

1-1/2" Sched 40 NPS Threaded Pipe

THREADED PIPE



PAINTED PIPE SECTIONS

Adaptive provides kits of pre-painted, fixed length section threaded pipe and safety cables for use in vertical suspensions of audio and video equipment and other objects. Secure any of these pipe sections above to one of Adaptive's heavy-duty ceiling mounts or strut channel adapters and a variety of adapters and mounts below.



KEY FEATURES:

- ▶ Pipe Sections are pre-threaded
- ▶ Body is powder coated black
- ▶ Pre measured safety cable included

OPTIONAL ACCESSORIES:

- ▶ See Ceiling Mount datasheet
- ▶ See Strut Attachment datasheet
- ▶ 1.5" to .5" Pipe Reducer (PIPE-1.5-500-PR)
- ▶ 1.5" Threaded Pipe Coupler (CG-150NPS-PC)
- ▶ .5" Threaded Pipe Coupler (PIPE-500-CPLNG)

SPECIFICATIONS:

Material: Schedule 40 Steel Pipe
Finish: Powder Coat
Color: Black
Design Factor: 7:1
Safety Cable: 285.7 lbs / 129.8 Kg.
WLL: 2051 lbs / 932 Kg.
Shipping Weight: See Table

PACKAGE CONTENTS:

1 pc Pipe, 1-1/2 NPS
1 pcs Safety Cable
1 pcs Flat Washer, 5/16"
1 pcs Quick Link, 1/4"

DIMENSIONS:

OPTIONAL THREADED PIPE COUPLERS

PIPE-1.5-500-PR

CG-150NPS-PC

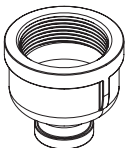

PIPE-1.5-500-PR
1.5X1.5 NPT TO 1/2-14 NPT

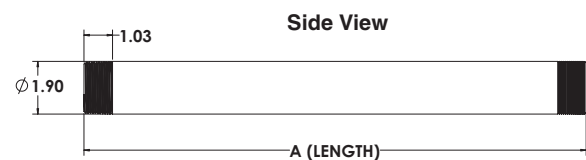

1-1/2" Part #:	A (Length)	Shipping Weight
PIPE-1.5NPS-12	12" Long Pipe	4.14 lbs/1.88 Kg.
PIPE-1.5NPS-18	18" Long Pipe	5.46 lbs/2.48 Kg.
PIPE-1.5NPS-24	24" Long Pipe	6.78 lbs/3.1 Kg.
PIPE-1.5NPS-30	30" Long Pipe	8.1 lbs/3.7 Kg.
PIPE-1.5NPS-36	36" Long Pipe	9.42 lbs/4.28 Kg.
PIPE-1.5NPS-48	48" Long Pipe	12.1 lbs/5.48 Kg.
PIPE-1.5NPS-60	60" Long Pipe	14.7 lbs/6.68 Kg.
PIPE-1.5NPS-72	72" Long Pipe	17.34 lbs/7.88 Kg.



Rated for indoor use.

Adaptive Technologies Group
 1635 E. Burnett Street | Signal Hill, CA 90755 USA
 Ph: 562.424.1100 | Fax: 562.424.3520
 www.adapttechgroup.com



ALWAYS INSTALL SAFETY CABLES

WARNING: Mounting and/or suspension of audio and video equipment requires experienced professionals. Improperly installed loudspeakers can result in property damage, personal injury and/or liability to the installing contractor.