

# MP-500NPT-CP

(110 lb. WLL)

CEILING PLATE FOR SCHED-40 1/2" DIA. THREADED PIPE

CEILING ATTACHMENT



## CEILING MOUNT

The MP-500NPT-CP provides a safe ceiling mounting plate for 1/2-14 threaded pipes. The ceiling plate can be installed to most horizontal overhead structures, including ceiling trusses, beams, Unistrut and other structural components.

The MP-500NPT-CP is designed to hold overhead speakers with a maximum weight of 80 lbs. We recommend a drop to the speaker of no longer than 48".



## KEY FEATURES:

- ▶ For overhead vertical load applications.
- ▶ Adapts to standard schedule-40 1/2" pipe.

## OPTIONAL ACCESSORIES:

- ▶ See Threaded Pipe Datasheet
- ▶ Thread Reducers - See Below

## SPECIFICATIONS:

**Material:** Structural Steel

**Finish:** Powder Coat

**Color:** Black

**WLL:** 110 lb / 50 Kg

**Design Factor:** 5:1

**Shipping Weight:** 2 lbs / .91 Kg.

## PACKAGE CONTENTS:

**1 pc** Ceiling Plate w/ 1/2-14NPS threads

**1 pc** Set screw, 1/4-20 x .25" long, black

## DIMENSIONS:

Ceiling Mount  
MP-500NPT-CP

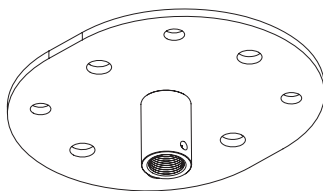

Top View

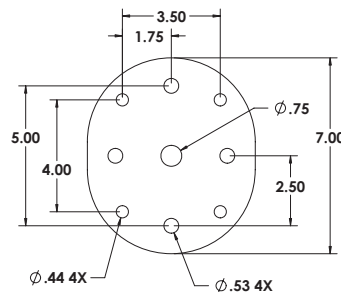

Side View

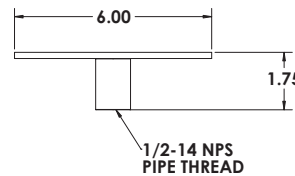

Reducer

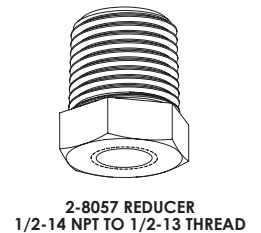

Rated for indoor use.

## ALWAYS INSTALL SAFETY CABLES

**WARNING:** Mounting and/or suspension of audio and video equipment requires experienced professionals. Improperly installed loudspeakers can result in property damage, personal injury and/or liability to the installing contractor.