

# MP-500NPT-TA

(110 lb. WLL)

CHANNEL STRUT ADAPTER FOR 1/2" SCHED-40 THREADED PIPE

STRUT ATTACHMENT



## ADAPTER FOR U- CHANNEL

The MP-500NPT-TA is a tube adapter that connects standard 1/2-14 sched-40 NPT pipes to channel strut. This adapter allows speakers and other objects to be mounted to channel strut using standard off the shelf 1/2-14 sched-40 NPT pipes.

The MP-500NPT-TA is designed to hold overhead objects with a maximum weight of 80 lbs. Maximum length of 48" long pipe is recommended.

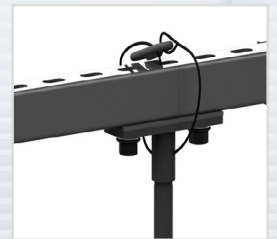

## KEY FEATURES:

- ▶ For overhead loudspeaker applications.
- ▶ Adapts to standard schedule-40 1/2" pipe.

## OPTIONAL ACCESSORIES:

- ▶ See Threaded Pipe Datasheet

## SPECIFICATIONS:

**Material:** Structural Steel

**Finish:** Powder Coat

**Color:** Black

**WLL:** 110 lb / 50 Kg

**Design Factor:** 5:1

**Shipping Weight:** 1.2 lbs / .55 Kg

## PACKAGE CONTENTS:

**1 pc** Tube Adapter, 1/2-14NPT/NPS

**1 pc** Sound Isolation Pad

**2 pcs** Flange bolt, 1/2"-13x1.5", blk

**2 pcs** lat washer w/ neoprene, 1/2

**2 pcs** Channel retainer nut, 1/2"-13

**1 pc** Set screw, 1/4-20

## DIMENSIONS:

MP-500NPT-TA  
Tube Adapter

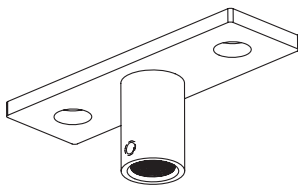

Top View

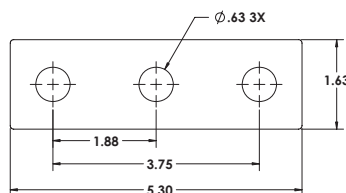

Front View

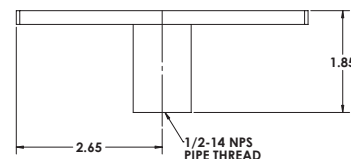

End View

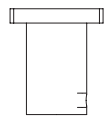

Rated for indoor use.

## ALWAYS INSTALL SAFETY CABLES

**WARNING:** Mounting and/or suspension of audio and video equipment requires experienced professionals. Improperly installed loudspeakers can result in property damage, personal injury and/or liability to the installing contractor.